

AXIUM CX

Ingenico Integrated POS Users Guide



Contents

1. Introduction	4
2. Presentation	5
2.1 Contain of the box	5
3. Overview of the AXIUM CX	6
3.1 Main components	6
3.2 Detailed view	9
4. Usage Instruction	10
4.1 How to use AXIUM CX with extended cable	10
4.2 Tilting Angles Of Smart Display	11
4.3 Power On/Power Off AXIUM CX	11
4.4 Reset / Power OFF Functions	11
4.5 Virtual Keys Function	12
4.6 Magnetic Swipe Reader	12
5. Troubleshooting	13
6. Installation	13
6.1 Checking Environment for Installation	13
7. Standards and Norms	14

8. Maintenance	18
8.1 Cleaning	18
8.2 Transport & maintenance	18
9. RED-DA (Radio Equipment Directive Delegated Act)	19

1. Introduction

We hope that you will be fully satisfied with your new AXIUM CX

Read this guide to understand and make the best use of your device. It presents you with the necessary information about use, installation, maintenance, safety and security recommendations.



WARRANTY / SECURITY

To benefit from the guarantee-related product, and to respect the security, we ask you to use only the power supply delivered in box with the product, entrusting maintenance operations only to an authorized person.

Failure to comply with these instructions will void the manufacturer's responsibility.



This symbol indicates an important Warning



This symbol indicates a piece of advice.

2. Presentation

2.1 Content of the box

- **AXIUM CX (without payment terminal and with extension cable if ordered)**
- **Users Guide**
- **Accessories Box containing:**
 - PSU 24V2A
 - If CX was ordered with extension cable, then the accessories box contains the extension cable and cable door.

For eventual Repair needs please keep the box to ship safely the AXIUM CX if needed.

The picture behows the AXIUM CX with an AXIUM RX9000 on the customer side (here on the left). The Terminal is managed seperately and is not part of the Box. Retail Terminal from Ingenico portfolio need to be added.



3. Overview of the AXIUM CX Series

3.1 Main components

AXIUM CX is composed of the main merchant screen, Hub iPOS CX and Power Supply 24V 2A.

1° AXIUM CX: Main Merchant Screen 15,6 inches

Smart Display 15,6 inches based on OPEN GMS Android is the main screen for the Merchant where Business applications will be installed.



2° AXIUM CX: Hub iPOS CX

The Hub iPOS CX has the following connectivity:

- RJ11
- RJ45 for ETHERNET
- 4 USB A 500mA
- DC Plug for PSU connection 24V - 2A
- Display Port to ensure the connectivity of the hub with Merchant Display

The Hub iPOS CX can permit the merchant to connect various accessories with USB connectivity like Printer, Scanner, Cash Drawer.

Accessories which can not be powered by USB 5V 500mA will have their own power supply (except the barcode reader).

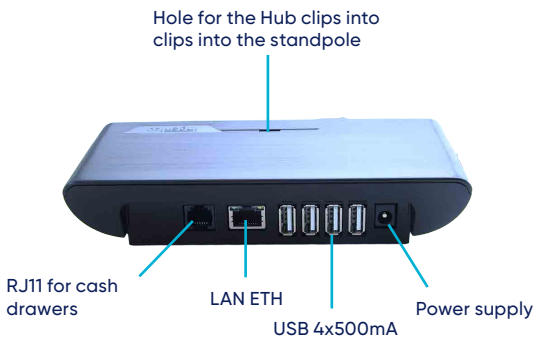

3° Configure the deported Hub with extension cable



4° AXIUM CX: Power Supply

The power supply which will be requested to power the AXIUM CX is supplied in the accessories box and corresponds to the PSU 24V 2A.

5° Terminal Payment

On the customer's side there could be Retail Payment Terminals like AXIUM RX5000, AXIUM RX7000 or AXIUM RX9000 or even Lane/3600 and Lane/7000 Terminals. See more guidelines about INGENICO Payment Retail terminals on our website www.ingenico.com.

6° AXIUM CX Dimensions:

Weight	3,870 kg
Dimension (LxWxH)	384,8 x203,5x 287
Electrical mains network	100-240VAC/50-60Hz Class II

3.2 Detailed view: Merchant Display

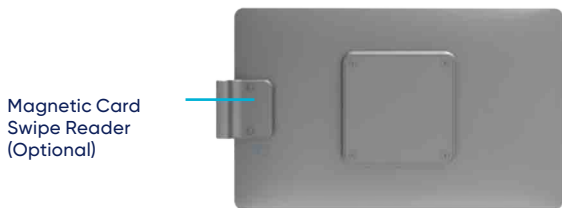
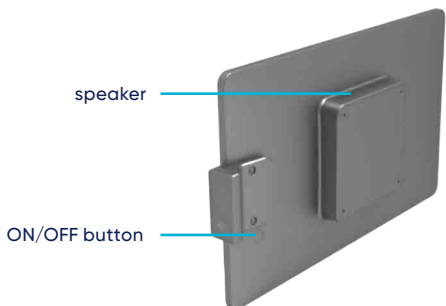

4.Usage Instruction

4.1 How to use AXIUM CX with extended cable

Please follow instructions below how to put off the IPOS Hub:

- 1) Take of the extention cable out of accesories box
- 2) Take out the Ipos Hub by pulling it out while puching the tab located above of the hub
- 3) Bend the cable in order to place the connection male-female displayport connector inside the Ipos.
- 4) Clip the extension cable on the inside Ipos Hub localization.
- 5)Clip de cable door on the Ipos



Please see below what should be internal cable position in order you could close the cable door.

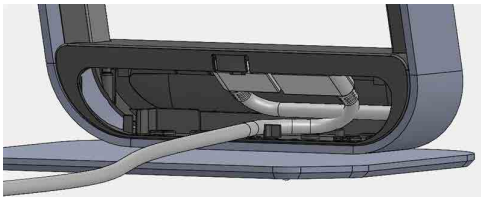

4.2 Tilting Angles of Smart Display

While transportation the Smart Display position is vertical (90°).

The inclination is adjustable depending on the final user usage. The maximum inclination is 45 degrees.

4.3 Power On AXIUM CX

To power the AXIUM CX please follow the next steps:

- Choose the power plug of your local country
- Plug the PSU cord into the power supply supplied in the BOX
- Plug the power supply into the DC jack of the Connection Hub
- Push the button ON during 3 sec situated on the rear side of the Merchant Display (see below).
- Automatically as soon as 24V is supplied.
- The Terminal Device will start automatically.

4.4 Reset / Power OFF Functions

1° How to Reset the Smart Display

Press <Power> button for more than 3 seconds. The screen will go OFF for a few seconds before it is lit again.

2° How to Power OFF the Smart Display

Press <Power> button for more than 2 seconds until the screen displays the menu, click <Power off> to complete shutdown.

3° How to force the Power OFF the Smart Display

If the device works abnormally, freezes or gets unresponsive, please long-press the power button for 10s, the device will automatically power off.

4.5 Virtual Keys Function

On the bottom side of the screen, it has 2 virtual buttons (order from left to right).

- Volume-Key : Control machine volume down
- Back Key: Used to return to the previous interface or exit the current application
- Home Key: To return to the desktop, press this button to return to the home screen
- Multitask Management Key: Used to view a list of recently opened applications and to switch or close applications in it
- Volume + Key: Control machine volume increase

4.6 Magnetic Swipe Reader

The merchants' display can be equipped with optional magnetic swipe reader for merchant's authentication. It can support cards Track 1/2/3, bidirectional swipe, ISO7810, ISO7811, ISO7812, ISO7813.

Magnetic Swipe is already mounted on the Merchant Display and can not be removed by user.

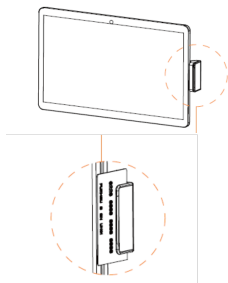

Insert the magnetic stripe card into the card slot of the card reader module to complete card recognition.

5.Troubleshooting

Power on/Power down - Emergency stop

To power on or power down the terminal, connect or disconnect the power supply from the electric outlet.



CAUTION

Only use the power supply recommended with AXIUM CX.

Electrical power supply network

The electrical outlet must meet the following criteria :

- Must be installed near the equipment and easily accessible;
- Must meet standards and regulations in the country of use;

Explosion areas

Certain regulations restrict the use of radio equipment in chemical plants, fuel depots and any site where blasting is carried out. You are urged to comply with these regulations. The AXIUM CX shall be protected by a specially fitted and certified cover enabling use in proximity to a fuel pump.

6.Installation

6.1 Checking Environment for Installation

Place the device onto a desk or table large and stable enough to support the weight of the system and peripherals to prevent it from dropping down. The device should be in an environment far away from heat source, and free from moisture, electromagnetic and electrical devices.

Temperature	Operating temperature	-0°C ~ 40°C
	Storage temperature	-20°C ~ 60°C
Relative Humidity	Operating humidity	5% ~ 95%, Non-condensing
	Storage humidity	

7. Standards and Norms

CE MARKING

The CE marking indicates the product complies with the requirements of European Directive 2014/53/EU on Radio Equipment for:

- The protection of the health and the safety of the user and any other person.
- The protection requirements with respect to electromagnetic compatibility.
- The protection requirements referred to network protection / data and personal privacy / fraud protection.

And complies with harmonized standards, as well as RoHS Directive 2011/65/ EU and its amendment directives.

Operating Frequency Band (RF)

Wi-Fi: 2412-2472MHz/5150-5350MHz/5470-5850MHz (TX/RX)

Bluetooth: 2402-2480 MHz(TX/RX)

Max. Of Transmit power EIRP :

Bluetooth: BR 14.25dBm BLE 4.61dBm 2.4G Wi-

Fi: 17.47dBm

5G Wi-Fi

band2/band2/Band3: 17.26dBm

5G Wi-Fi

band4: 13.42dBm

Restrictions in the 5GHz band:

According to Article 10(10) of Directive 2014/53/EU, the packaging shows that this device will be subject to some restrictions when placed on the market.

In all EU member states, operation of 5150-5350MHz is restricted to indoor use only.



AT	BE	CY	CZ	DK	EE	FI
FR	DE	EL	HU	IE	IT	LV
LT	LU	MT	NL	PL	PT	SK
SI	ES	SE	UK	BG	RO	HR

Environment (WEEE,)

This product is labeled in accordance with European Directives 2012/19/EU concerning Waste Electrical and Electronic Equipment (WEEE) and 2013/56/EU concerning Batteries and Accumulators. Those provisions are requiring producers and manufacturers to become liable for take-back, treatment and recycling upon end of life of equipment and batteries.

BATTERIES

If your product contains batteries, they must be disposed of at appropriate collection points.

WARNING

Do not ingest the battery, Chemical Burn Hazard (The remote control supplied with) This product contains a coin/button cell battery. If the coin/button cell battery is swallowed, it can cause severe internal burns in just 2 hours and can lead to death.

Keep new and used batteries away from children.

If the battery compartment does not close securely, stop using the product and keep it away from children.

If you think batteries might have been swallowed or placed inside any part of the body, seek immediate medical attention.

Replacement of a battery with an incorrect type that can defeat a safe guard;

Disposal of a battery into fire or a hot oven, or mechanically crushing or cutting of a battery, that can result in an explosion.

Leaving a battery in an extremely high temperature surrounding environment that can result in an explosion or the leakage of flammable liquid or gas

A battery subjected to extremely low air pressure that may result in an explosion or the leakage of flammable liquid or gas

THE PRODUCT



The crossed-out waste bin stuck on the product or its accessories means that the product belongs to the family of electrical and electronic equipment, and waste batteries must not be thrown away but collected separately and recycles.

Please contact your retailers for more detailed information about the compliance solution in place for disposing of your old product and used batteries.

Packaging waste must also be collected separately to assure a proper disposal and recycling.

In this way you can participate in the re-use and upgrading of Electrical and Electronic Equipment Waste, which can have an effect on the environment and human health.

The power supply label contains symbols:



International Efficiency Marking Protocol (Energy Star Level 6).



In door use only



"Conformité Européenne" or CE Mark



Double insulation symbol



Recycle in accordance with the waste electronic & electrical equipment directive.



Made from recyclable material



Risk of explosion if the battery is incorrectly replaced or is laced in a fire

8.Maintenance

8.1 Cleaning

Unplug all the wires from the device.

Good rules for proper cleaning of the device are:

- Use pre-impregnated wipes to clean the outside of device.
- Do not clean the electrical connections.
- Do not use in any case, solvents, detergents or abrasive products: Those materials might damage the plastic or electrical contacts.
- Avoid exposing the device to the direct rays of the sun.

8.2 Transport & maintenance

Adopt general transportation mode, and prevent the goods from sunlight, snow, shower and mechanical impact. Transport the devices with care, do not throw it forcibly. Prevent the packaging from extrusion during transportation, to avoid breakage.

The product should be stored in the original packaging box. The warehouse is not allowed to have all sorts of harmful gases, inflammable, explosive, corrosive chemical goods, strong mechanical vibration and strong magnetic field. Packing box should be at least 15cm above the ground, and be away from heat, cold, window or air inlet source at least 50cm.

9.REDA (Radio Equipment Directive Delegated Act)

The product has been designed and manufactured in accordance with the essential requirements of the **RED DA** (Radio Equipment Directive Delegated Act), as set out in **Commission Delegated Regulation (EU) 2022/30 of 29 October 2021** supplementing **Directive 2014/53/EU** of the European Parliament and of the Council with regard to the application of the essential requirements referred to in **Article 3(3)**, points (d), (e) and (f).

- **Article 3.3 (d)** : Network Protection
- **Article 3.3 (e)** : Data and Privacy Protection
- **Article 3.3 (f)** : Fraud Prevention

RED DA aspects have been assessed and tested in accordance with the harmonized standard **EN 18031: «Common security requirements for radio equipment»**, ensuring alignment with the essential cybersecurity requirements of **Directive 2014/53/EU**. This applies to the relevant categories and classes of radio equipment as specified in **Delegated Regulation (EU) 2022/30**.

The assessment remains valid as long as the hardware and software integration – including all relevant applications – continues to comply with the requirements set forth by the applicable RED DA. Any additional software should follow RED DA requirements to remain EU compliant.

Please contact Ingenico support for more information (<https://www.ingenico.com>).

"This Document is Copyright © 2026 by INGENICO Group. INGENICO retains full copyright ownership, rights and protection in all material contained in this document. The recipient can receive this document on the condition that he will keep the document confidential and will not use its contents in any form or by any means, except as agreed beforehand, without the prior written permission of INGENICO. Moreover, nobody is authorized to place this document at the disposal of any third party without the prior written permission of INGENICO. If such permission is granted, it will be subject to the condition that the recipient ensures that any other recipient of this document, or information contained therein, is held responsible to INGENICO for the confidentiality of that information.

Care has been taken to ensure that the content of this document is as accurate as possible. INGENICO however declines any responsibility for inaccurate, incomplete or outdated information. The contents of this document may change from time to time without prior notice, and do not create, specify, modify or replace any new or prior contractual obligations agreed upon in writing between INGENICO and the user.

INGENICO is not responsible for any use of this device, which would be non-consistent with the present document.

All trademarks used in this document remain the property of their rightful owners."

Your contact

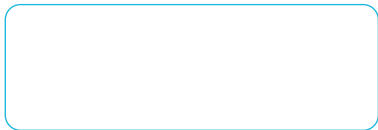

296325617

www.ingenico.com

13-17 rue Pagès, 92150 Suresnes – France

Banks and Acquirers International Holding SAS / 814 767 216 RCS Nanterre